

## STEP 1

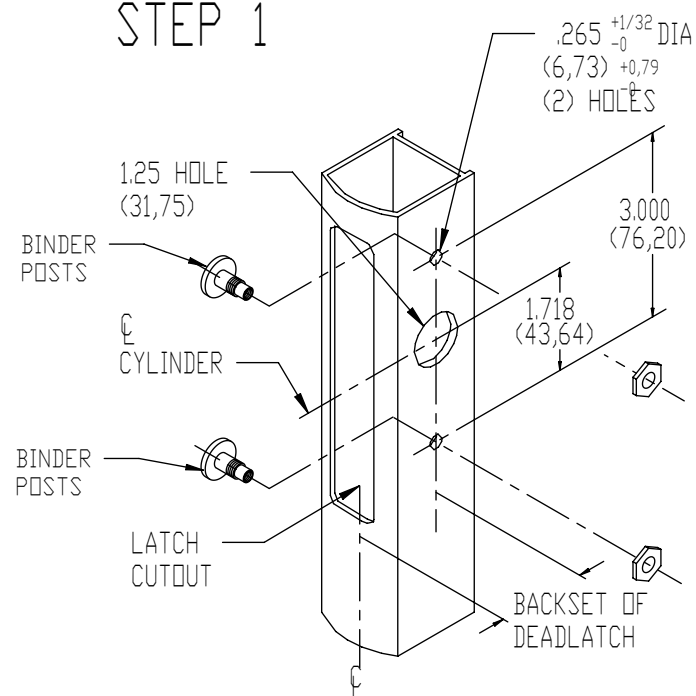

1. PREPARE STILE AS SHOWN.
2. INSERT BINDER POST THRU .265 DIA. HOLE IN STILE.
3. SECURE BINDER POST WITH 1/4-28 NUT.  
(CAUTION: DO NOT OVERTIGHTEN NUT)

## STEP 2

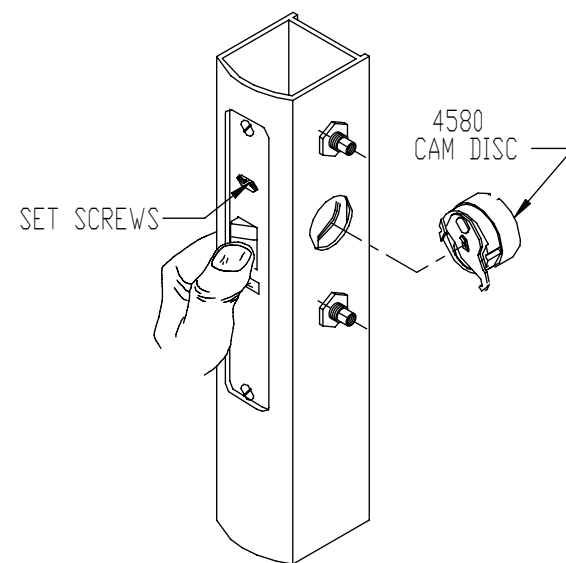

1. INSTALL 4500, 4700 AND 4900 SERIES DEADLATCH PER MOUNTING INSTRUCTIONS.
2. INSTALL 4580 CAM DISC ASSY. SECURE WITH SETSCREW.

## INSTALLATION

## STEP 3

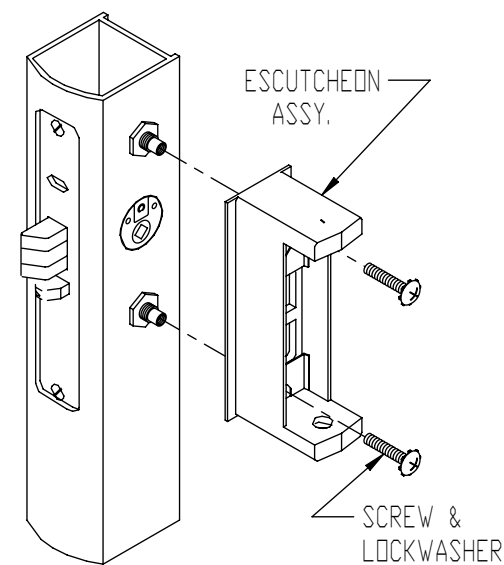

1. INSTALL ESCUTCHEON ASSY.
2. USING 8-32 SCREWS W/LOCKWASHER, SECURE ESCUTCHEON ASSY. TO BINDER POST.  
**IMPORTANT,**  
TIGHTEN THESE SCREWS SECURELY.

## STEP 4

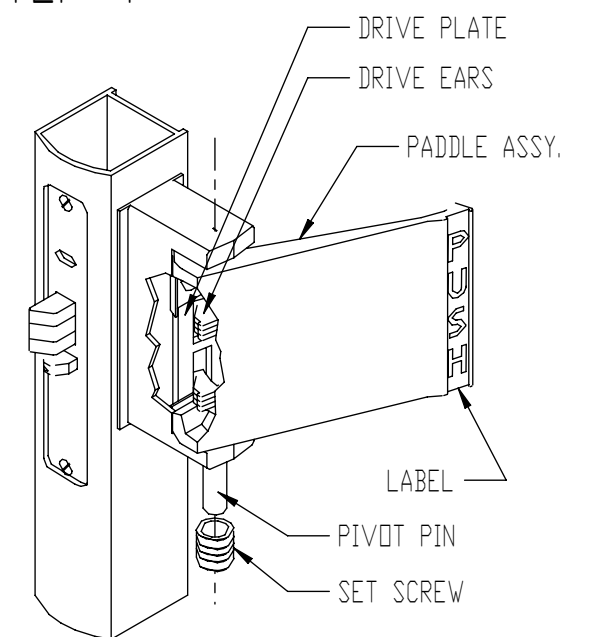

1. INSTALL PADDLE ASSY. ALIGN DRIVE EARS ON PADDLE WITH SLOT IN DRIVE PLATE.
2. INSTALL PIVOT PIN.
3. INSTALL PIVOT PIN SET SCREW. TIGHTEN SET SCREW FLUSH WITH BOTTOM OF ESCUTCHEON.

## INSTRUCTIONS FOR CHANGING HAND SEE REVERSE FOR CAM DISC ASSY.

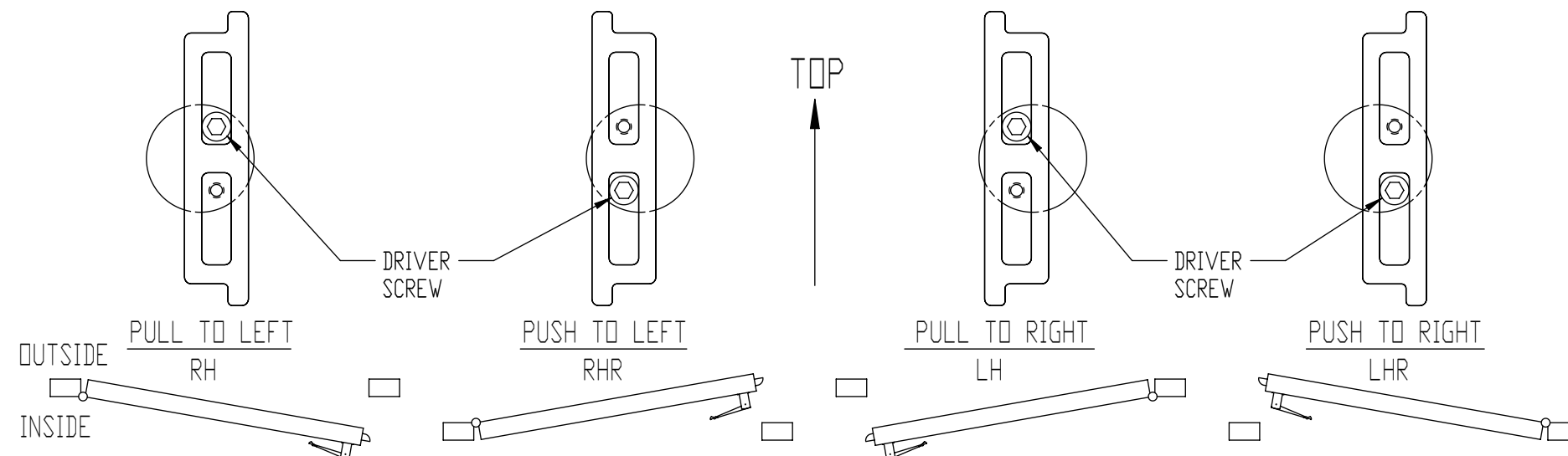

1. FIND DESIRED CONFIGURATION.
2. REMOVE KEEPERS TO SEE LOCATION OF SPRINGS & DRIVER PLATE.
3. REVERSE SPRINGS & DRIVER PLATE IF NECESSARY.
4. REMOVE DRIVER SCREW IF NECESSARY, AND PLACE IN DESIRED LOCATION.

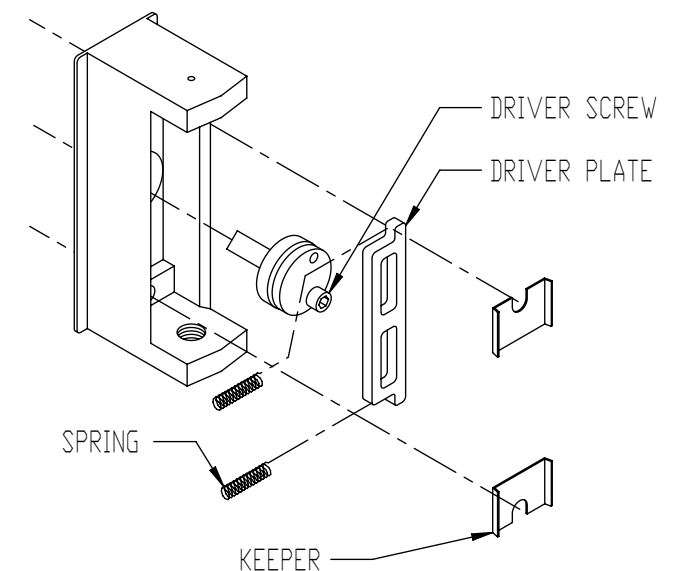

5. REPLACE KEEPERS.
6. CONFIGURE CAM DISC. (SEE REVERSE)

# 4580 CAM DISC HANDING

LOOKING AT THE EDGE OF THE DOOR, DETERMINE ON WHICH SIDE THE HANDLE OR OTHER OPERATOR IS TO BE INSTALLED.



**TRADEMARK  
HARDWARE**

WWW.TMHARDWARE.COM

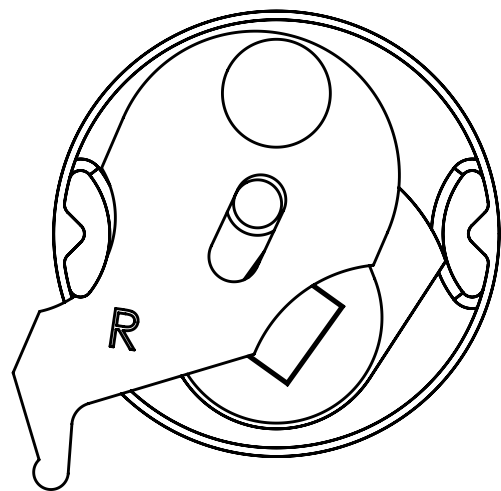

THE CAM DISC MUST BE  
HANDED AS SHOWN.



**ON THIS SIDE**

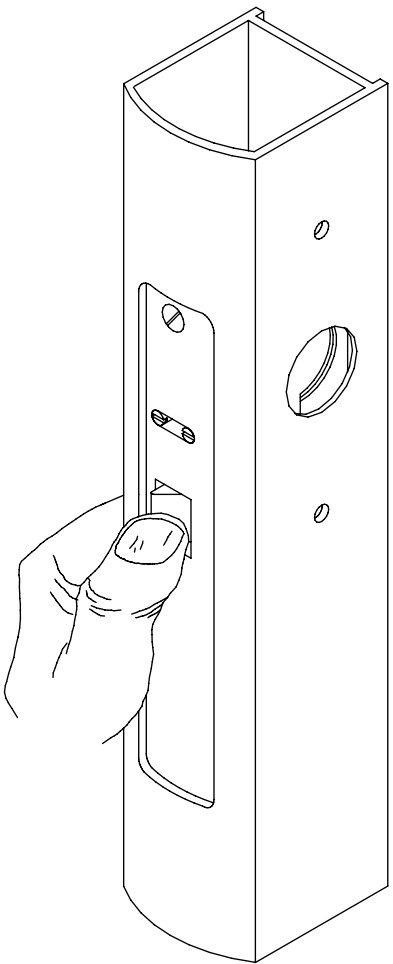

**ON THIS SIDE**

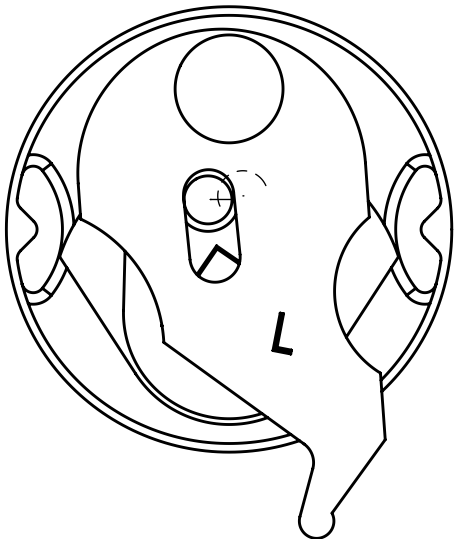

THE CAM DISC MUST BE  
HANDED AS SHOWN.

## INSTRUCTIONS FOR CHANGING HAND OF 4580 CAM DISC

### STEP 1

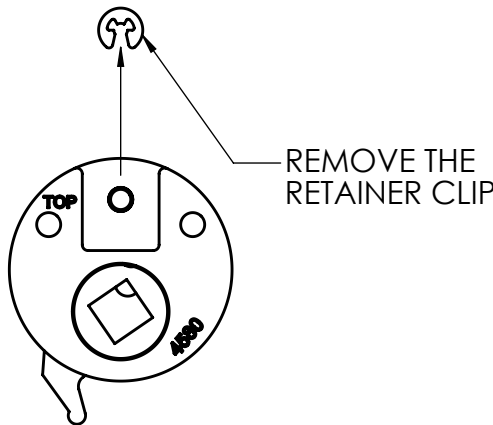

REMOVE THE  
RETAINER CLIP

### STEP 2

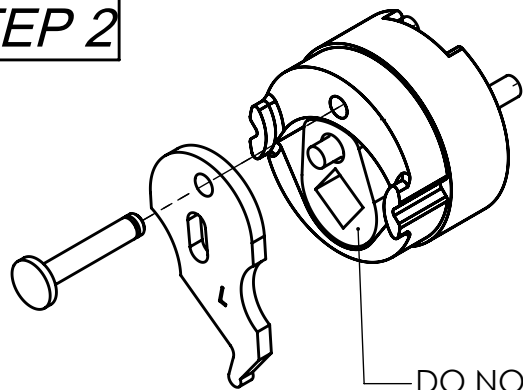

DO NOT REMOVE  
THE DRIVER PIECE

PULL THE CAM PIVOT PIN OUT  
OF THE CAM DISC AS SHOWN.

### STEP 3

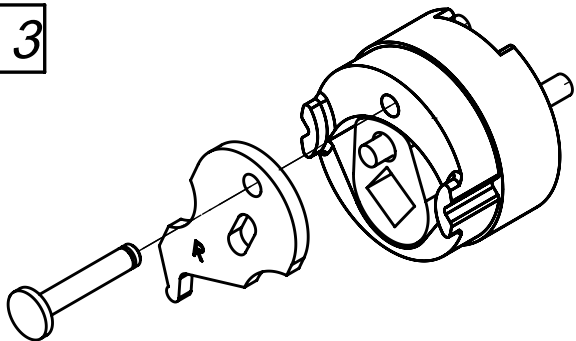

TURN THE CAM OVER AND PUSH  
THE CAM PIVOT PIN THRU THE  
CAM AND INTO THE CAM DISC  
AS SHOWN.

### STEP 4

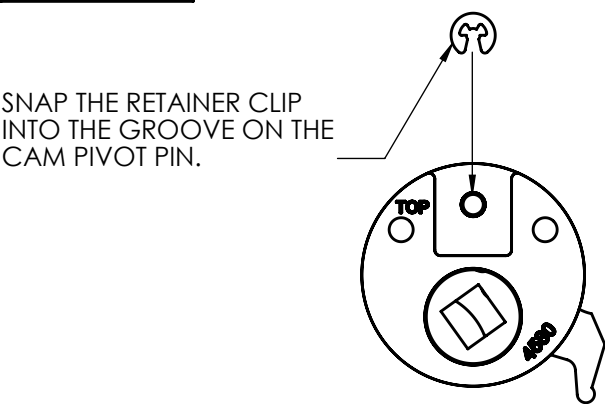

SNAP THE RETAINER CLIP  
INTO THE GROOVE ON THE  
CAM PIVOT PIN.



www.adamsrite.com  
Phone: 800-626-7590  
800-872-3267

**ASSA ABLOY**

Fax: 866-582-4641  
800-232-7329

4591 PADDLE OPERATOR

80-0180-200

Rev. E

ECN: 11955A

Date: 06-19-12

INSTALLATION INSTRUCTIONS

Page 2 of 2 Appvd: MP Date: 06-19-12