

## 1. Thread Drive Bar Cylinder

Use Cylinder Key to thread Drive Bar Cylinder clockwise on interior side of door.

Note: Drive Bar Socket must be in the 12 o' clock position as shown.

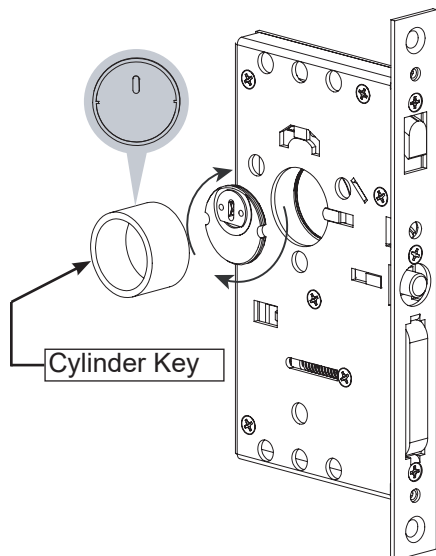

Note: Notches on cylinder must be parallel with the horizontal plane when fully screwed into lock body.

## 2. Install Lock Body

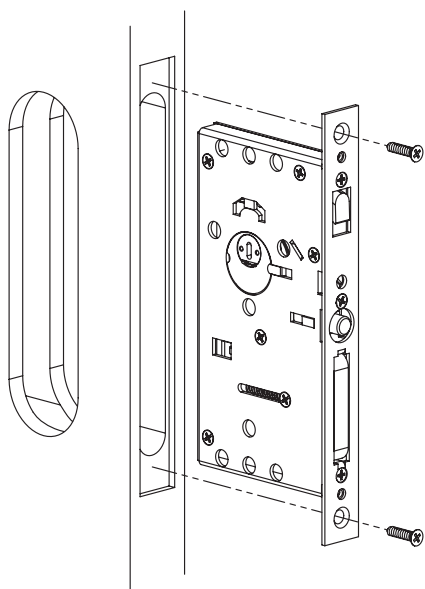

See template for door prep specifications

## 3. Install Inside and Outside Plates

Inside

TRIMS VARY NARROW OVAL SHOWN

Outside

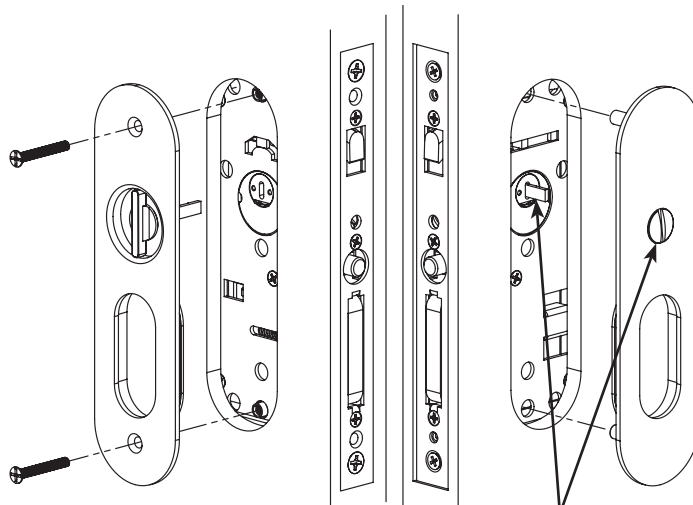

Align Passage/Privacy button with Thumb-turn spindle and secure trim plates to door.

## 4. Tighten Key Cylinder

Tighten locking screw to engage notches on cylinder

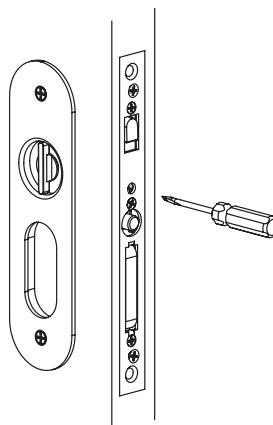

## 5. Install Trim Plate

Door Jamb Prep.

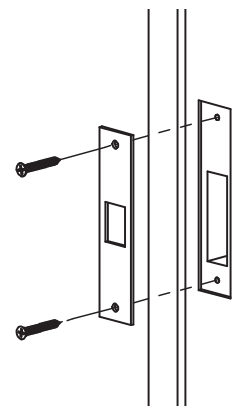
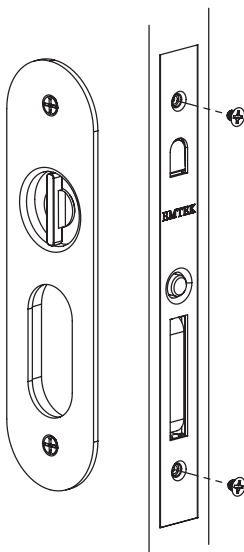

See template for door jamb prep specifications