

Grass TIOMOS



Features

- > A hinge system for all door applications
- > With 3 soft close settings, invisibly integrated in hinge arm
- > Improved kinematics reduces opening force and minimizes reveals
- > Full overlay application achieved with 2 version hinges
- > 3 dimensional adjustment
- > Side adjustment: ± 2 mm (1/16") with overturn stop
- > Depth adjustment: from -2/+3 mm (-1/16"/+1/8") via self-locking worm gear
- > Height adjustment: ± 2.5 mm depending on the mounting plate
- > Meets and exceeds ANSI/BHMA 156.9 Standard



Adjustment facility of soft close



For large and heavy doors

The damping effect is increased by turning the adjustment lever to the right by 90°



For standard doors

Adjustment lever in the horizontal position - factory setting



For small and lightweight doors

A softer damping effect is achieved by turning the adjustment lever to the left by 90°

Number of concealed hinges per door

- > The number of concealed hinges per door depends on: Door width, height, weight and material
- > The values in the diagram are sample measurements and refer to a standard door width of 600 mm (23 5/8").
- > If in doubt, determine the number of hinges by trial mounting.
- > According to the example diagram, four concealed hinges should be mounted with a door height of 2 m (6' 6 3/4") x 600 mm (23 5/8") and a door weight of 13 kg (29 lbs.).

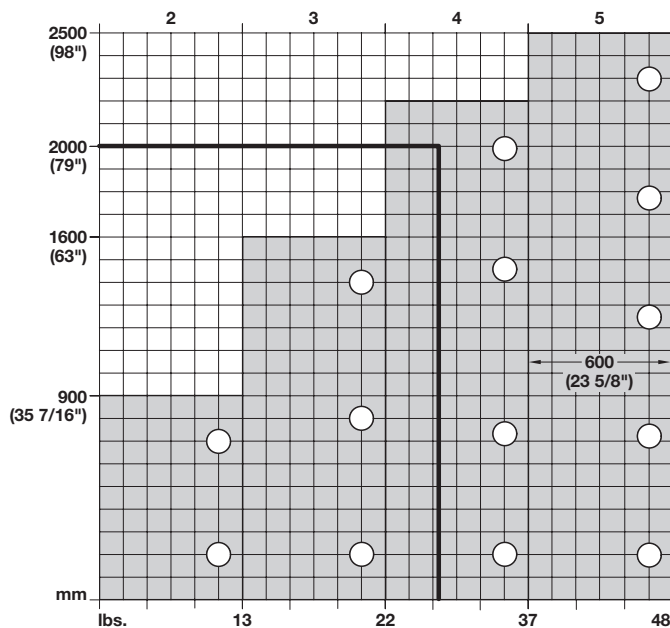

Grass TIOMOS



> The reveal (R) is the distance required between the door and the side wall or between 2 doors to allow sufficient space for opening the door. The required reveal (R) depends on the door thickness.

Full overlay plus/full overlay mounting

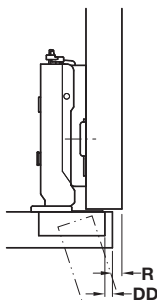

Half overlay/twin mounting

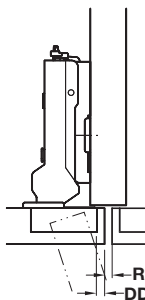

Inset mounting

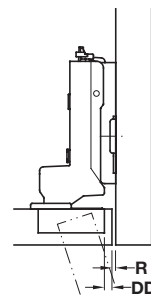

Minimum Reveal

110°

Door thickness	Distance to cup DD				
	3	4	5	6	7
16	.6	.6	.6	.6	.6
17	.6	.6	.6	.6	.6
18	.7	.7	.7	.7	.7
19	.9	.9	.9	.9	.9
20	1.1	1.1	1.1	1.1	1.1
21	1.4	1.3	1.3	1.3	1.3
22	1.6	1.6	1.6	1.5	1.5
24	2.4	2.1	2.1	2.1	2
Minimum reveal R					

120°

Door thickness	Distance to cup DD				
	3	4	5	6	7
16	.6	.6	.6	.6	.6
17	.6	.6	.6	.6	.6
18	.7	.7	.7	.7	.7
19	.9	.9	.9	.9	.9
20	1.1	1.1	1.1	1.1	1.1
21	1.4	1.3	1.3	1.3	1.3
22	3	2	1.5	1.5	1.5
24	6.4	5.4	4.4	3.4	2.4
Minimum reveal R					

30°/45° angle hinge

Door thickness	Distance to cup DD				
	3	4	5	6	7
16	.6	.6	.6	.6	.6
17	.6	.6	.6	.6	.6
18	.7	.7	.7	.7	.7
19	.9	.9	.9	.9	.9
20	1.1	1.1	1.1	1.1	1.1
21	1.4	1.3	1.3	1.3	1.3
22	1.6	1.6	1.6	1.5	1.5
24	2.4	2.1	2.1	2.1	2
Minimum reveal R					

Note

Minimum gap for doors with radius edges (r = 1 mm) with factory setting.

160°

Door thickness	Distance to cup DD						
	3	4	5	6	7	8	9
29	.2	.2	.2	.2	.2	.2*	.2*
30	.2	.2	.2*	.2*	.2*		
31	.2*	.2*	.2*	.2*			
32	.2*	.2*					
Minimum reveal R							

Note

Minimum reveal R: No minimum gap is required for door thickness 16–28 mm. We recommend trial mounting from a door thickness of 29 mm (1 1/8") and above. 29–32 mm (1 1/8"–1 1/4") *require reduction clip.

Hinges and Stays

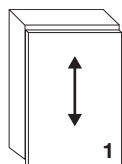

1
Height adjustment
+/- 2 mm

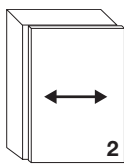

2
Side adjustment
+/- 2 mm

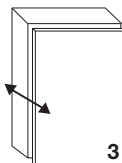

3
Depth adjustment
+3/-2 mm

All adjustments can be carried out independently of each other

Side adjustment

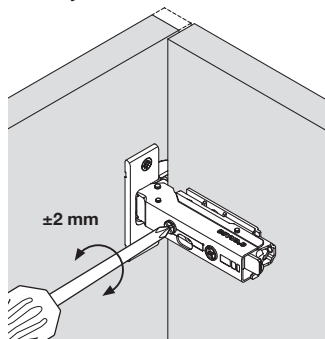

Depth adjustment via worm gear

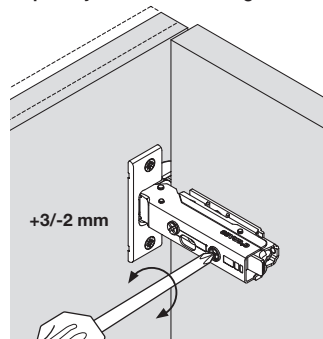

Height adjustment via base plate

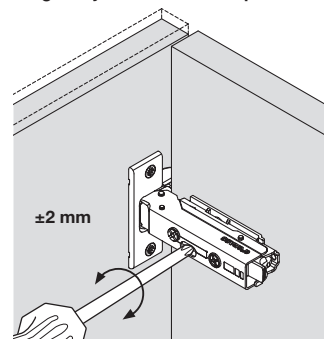

Dimensional data not binding. Dimensions in mm, inches are approximate. We reserve the right to alter specifications without notice.

